



Common Land Unit Tract Boundary

- Non-Cropland
- Cropland

Wetland Determination Identifiers

- Restricted Use
- Limited Restrictions
- Exempt from Conservation Compliance Provisions

Unless noted on field:

- | | |
|--------------------------|-------------------------|
| 1/ All Wheat HRW, NI, GR | 6/ Sorghum, GRS, NI, GR |
| 2/ All Wheat HRW, IR, GR | 7/ Sorghum, GRS, IR, GR |
| 3/ All Corn YEL, IR, GR | 8/ Sorghum, CAN, IR, FG |
| 4/ All Corn YEL, NI, GR | 9/ Grass, NAG, NI, GZ |
| 5/ Soybeans, COM, IR, GR | 10/ Alfalfa, IR, FG |

Tract Cropland Total: 63.15 acres

2024 Program Year

Map Created October 13, 2023

Farm 2868

Tract 140

24-32-34

Displayed over 2021 NAIP



Form: FSA-156EZ

See Page 2 for non-discriminatory Statements.

Abbreviated 156 Farm Record

Operator Name : CLAWSON RANCH PARTNERSHIP
 CRP Contract Number(s) : None
 Recon ID : 20-175-2014-15
 Transferred From : None
 ARCPLC G//F Eligibility : Eligible

Farm Land Data

Farmland	Cropland	DCP Cropland	WBP	EWP	WRP	GRP	Sugarcane	Farm Status	Number Of Tracts
120.62	63.15	63.15	0.00	0.00	0.00	0.00	0.0	Active	1
State Conservation	Other Conservation	Effective DCP Cropland	Double Cropped		CRP	MPL	DCP Ag.Rel. Activity	SOD	
0.00	0.00	63.15	0.00		0.00	0.00	0.00	0.00	

Crop Election Choice

ARC Individual	ARC County	Price Loss Coverage
None	None	None

DCP Crop Data

Crop Name	Base Acres	CCC-505 CRP Reduction Acres	PLC Yield	HIP

NOTES

--

Tract Number : 140
 Description : E/2oSW/4 & SW/4oSE/4 24-32-34(grass) D6
 FSA Physical Location : KANSAS/SEWARD
 ANSI Physical Location : KANSAS/SEWARD
 BIA Unit Range Number :
 HEL Status : HEL field on tract.Conservation system being actively applied
 Wetland Status : Wetland determinations not complete
 WL Violations : None
 Owners : HITCH ENTERPRISES INC
 Other Producers : PREMIUM SOURCE AG LLC
 Recon ID : None

Tract Land Data

Farm Land	Cropland	DCP Cropland	WBP	EWP	WRP	GRP	Sugarcane
120.62	63.15	63.15	0.00	0.00	0.00	0.00	0.0
State Conservation	Other Conservation	Effective DCP Cropland	Double Cropped	CRP	MPL	DCP Ag. Rel Activity	SOD
0.00	0.00	63.15	0.00	0.00	0.00	0.00	0.00



Abbreviated 156 Farm Record

DCP Crop Data

Tract 140 Continued ...

Crop Name	Base Acres	CCC-505 CRP Reduction Acres	PLC Yield
-----------	------------	-----------------------------	-----------

NOTES

In accordance with Federal civil rights law and U.S. Department of Agriculture (USDA) civil rights regulations and policies, the USDA, its Agencies, offices, and employees, and institutions participating in or administering USDA programs are prohibited from discriminating based on race, color, national origin, religion, sex, gender identity (including gender expression), sexual orientation, disability, age, marital status, family/parental status, income derived from a public assistance program, political beliefs, or reprisal or retaliation for prior civil rights activity, in any program or activity conducted or funded by USDA (not all bases apply to all programs). Remedies and complaint filing deadlines vary by program or incident.

Persons with disabilities who require alternative means of communication for program information (e.g., Braille, large print, audiotape, American Sign Language, etc.) should contact the responsible Agency or USDA's TARGET Center at (202) 720-2600 (voice and TTY) or contact USDA through the Federal Relay Service at (800) 877-8339. Additionally, program information may be made available in languages other than English.

To file a program discrimination complaint, complete the USDA Program Discrimination Complaint Form, AD-3027, found online at http://www.ascr.usda.gov/complaint_filing_cust.html and at any USDA office or write a letter addressed to USDA and provide in the letter all of the information requested in the form. To request a copy of the complaint form, call (866) 632-9992. Submit your completed form or letter to USDA by: (1) mail: U.S. Department of Agriculture Office of the Assistant Secretary for Civil Rights 1400 Independence Avenue, SW Washington, D.C. 20250-9410; (2) fax: (202) 690-7442; or (3) e-mail: program.intake@usda.gov. USDA is an equal opportunity provider, employer, and lender.

Water Right Information represents conditions as of 06/02/2024.

Water Right

Water Right:
22218 - 00

Use:
IRR

Pd:
24-32S-34W 2

Water Right Details

Source:
G

Right Type:
Appropriation

Total Acres Authorized:
2120.00

Net Acres Authorized:
0

Water Right Active:
1

Water Right Status:
CERTIFICATE ISSUED

Place(s) of Use:

24-32S-34W	NE NW	(active)	Total Acres: 40,	Net Acres: 0
25-32S-34W	NE SW	(active)	Total Acres: 40,	Net Acres: 0
25-32S-34W	SE SW	(active)	Total Acres: 40,	Net Acres: 0
26-32S-34W	NE NE	(active)	Total Acres: 40,	Net Acres: 0
26-32S-34W	SW NE	(active)	Total Acres: 40,	Net Acres: 0
24-32S-34W	NE SW	(active)	Total Acres: 40,	Net Acres: 0
24-32S-34W	SE SW	(active)	Total Acres: 40,	Net Acres: 0
23-32S-34W	SW SW	(active)	Total Acres: 40,	Net Acres: 0
24-32S-34W	SW SW	(active)	Total Acres: 40,	Net Acres: 0
24-32S-34W	NW NW	(active)	Total Acres: 40,	Net Acres: 0
25-32S-34W	SW NE	(active)	Total Acres: 40,	Net Acres: 0
25-32S-34W	SE NW	(active)	Total Acres: 40,	Net Acres: 0
36-32S-34W	NE NE	(active)	Total Acres: 40,	Net Acres: 0
36-32S-34W	SW NE	(active)	Total Acres: 40,	Net Acres: 0
36-32S-34W	NE NW	(active)	Total Acres: 40,	Net Acres: 0
36-32S-34W	SW NW	(active)	Total Acres: 40,	Net Acres: 0
26-32S-34W	SE SE	(active)	Total Acres: 40,	Net Acres: 0
26-32S-34W	SW SE	(active)	Total Acres: 40,	Net Acres: 0
23-32S-34W	NE SW	(active)	Total Acres: 40,	Net Acres: 0
23-32S-34W	NW SW	(active)	Total Acres: 40,	Net Acres: 0
24-32S-34W	NW SW	(active)	Total Acres: 40,	Net Acres: 0
25-32S-34W	NE NW	(active)	Total Acres: 40,	Net Acres: 0
25-32S-34W	SW SW	(active)	Total Acres: 40,	Net Acres: 0

26-32S-34W	SE NE	(active)	Total Acres: 40,	Net Acres: 0
23-32S-34W	NE NE	(active)	Total Acres: 40,	Net Acres: 0
23-32S-34W	NW NW	(active)	Total Acres: 40,	Net Acres: 0
23-32S-34W	SW NW	(active)	Total Acres: 40,	Net Acres: 0
24-32S-34W	SE NW	(active)	Total Acres: 40,	Net Acres: 0
25-32S-34W	NW NE	(active)	Total Acres: 40,	Net Acres: 0
36-32S-34W	NW NE	(active)	Total Acres: 40,	Net Acres: 0
36-32S-34W	SE NE	(active)	Total Acres: 40,	Net Acres: 0
36-32S-34W	NW NW	(active)	Total Acres: 40,	Net Acres: 0
36-32S-34W	SE NW	(active)	Total Acres: 40,	Net Acres: 0
23-32S-34W	SE NW	(active)	Total Acres: 40,	Net Acres: 0
23-32S-34W	NW SE	(active)	Total Acres: 40,	Net Acres: 0
23-32S-34W	SW SE	(active)	Total Acres: 40,	Net Acres: 0
26-32S-34W	NW NE	(active)	Total Acres: 40,	Net Acres: 0
26-32S-34W	NW SE	(active)	Total Acres: 40,	Net Acres: 0
24-32S-34W	SW NW	(active)	Total Acres: 40,	Net Acres: 0
23-32S-34W	NE SE	(active)	Total Acres: 40,	Net Acres: 0
25-32S-34W	NW SE	(active)	Total Acres: 40,	Net Acres: 0
25-32S-34W	NW SW	(active)	Total Acres: 40,	Net Acres: 0
35-32S-34W	SW NE	(active)	Total Acres: 40,	Net Acres: 0
23-32S-34W	NW NE	(active)	Total Acres: 40,	Net Acres: 0
23-32S-34W	SE NE	(active)	Total Acres: 40,	Net Acres: 0
23-32S-34W	SW NE	(active)	Total Acres: 40,	Net Acres: 0
23-32S-34W	NE NW	(active)	Total Acres: 40,	Net Acres: 0
23-32S-34W	SE SW	(active)	Total Acres: 40,	Net Acres: 0
23-32S-34W	SE SE	(active)	Total Acres: 40,	Net Acres: 0
26-32S-34W	NE SE	(active)	Total Acres: 40,	Net Acres: 0
35-32S-34W	NE NE	(active)	Total Acres: 40,	Net Acres: 0
35-32S-34W	NW NE	(active)	Total Acres: 40,	Net Acres: 0
35-32S-34W	SE NE	(active)	Total Acres: 40,	Net Acres: 0

Priority Date:
04/05/1974

Point of Diversion Details

Action Trail:

04/05/1974- PENDING INITIAL REVIEW
08/12/1975- APPROVED PENDING COMPLETION
12/30/1975- COMPLETED PENDING INSPECTION
04/30/1987- INSPECTED PENDING PERFECTION
06/04/1987- CHANGE APPLICATION FOR PLACE OF USE
06/29/1987- CERTIFICATE ISSUED
03/18/1988- CHANGE APPLICATION FOR PLACE OF USE
04/21/1988- CHANGE APPROVED
06/01/1988- CHANGE DISMISSED PRIOR TO APPROVAL

Pd Active:
1

Feet North:
1297

Feet West:
5170

Qualifiers:
CW SW

County:
SEWARD

GMD Num:
3

Number of Wells:
1

Subbasin:
CIMARRON RIVER

Stream:

Special Use Area(s):

Comment:
WELL #6

Authorized Quantity and Rate

Quantity Stored By:
Water Right

Authorized Quantity (AF):
130

Net Quantity (AF):
130

Rate Stored By:
Water Right

Authorized Rate (GPM):
930

Net Rate (GPM):
930

Reported Water Use

Water Use Year:
2022

Total Water Used (AF):
108.00

Acres Irrigated:
79

Water Use Reported on Right Num:

Reel Number:
21

Blip Number:
5955

Metered Quantity:
108

Meter Unit:
2

Beginning Meter Reading:
617

Ending Meter Reading:
725

Depth to Water:

Depth of Well:

System Type:
4

Hours Pumped:

Pump Rate:

Date of Measurement:

Date Report Received:
02/15/2023

Chemigation Indicator:
1

Water Use Code:
A

Crop Code:
25

Current Water Use Correspondent(s):
CLAWSON LAND PARTNERSHIP

Soil Map—Seward County, Kansas
(Hitch Soils (Bobbie))

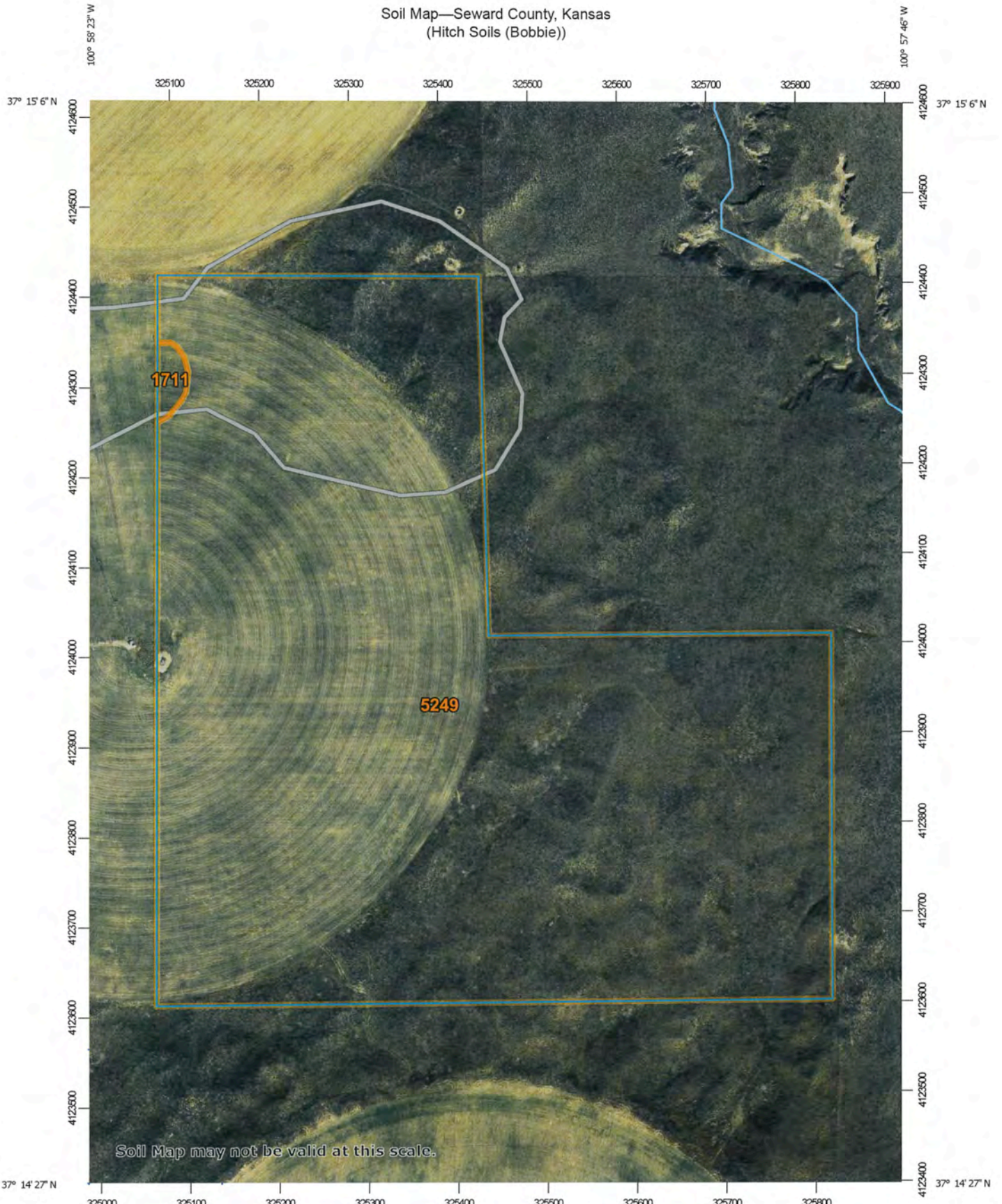

Map Scale: 1:5,860 if printed on A portrait (8.5" x 11") sheet.

0 50 100 200 300 Meters

0 250 500 1000 1500 Feet

Map projection: Web Mercator Corner coordinates: WGS84 Edge tics: UTM Zone 14N WGS84

Map Unit Legend

Map Unit Symbol	Map Unit Name	Acres in AOI	Percent of AOI
1711	Otero-Mansic complex, 1 to 4 percent slopes	0.6	0.5%
5249	Optima fine sand, 10 to 25 percent slopes	112.2	99.5%
Totals for Area of Interest		112.8	100.0%